

# PRE-LEASE

1000 Commerce Drive, Peachtree City, GA 30269

**Medical Office Space BTS | Westpark Commercial Center**



## PROPERTY DETAILS

- Medical office space for lease
- New addition for build-to-suit space
- Suite sizes from 2,000 to 4,000 SF
- All suites sub metered for electricity usage
- All medical co-tenants
- Parking ratio: 5/1,000
- Established commercial area in central Peachtree City
- Great access to state routes 74 and 54
- Close proximity to dining, shopping, hotels, and fitness
- Golf cart accessible
- Lease Rate: \$22.00/SF NNN

**Office: 770-631-0499**

**Web: [stcom.us](http://stcom.us)**

*This information has been secured from sources we deem reliable, but we make no representations or warranties, expressed or implied as to the accuracy of the information.*



**SOUTHTREE**  
COMMERCIAL

**REAL ESTATE**

**Paul Schwinne, CCIM**

Broker

678-296-1588

[pschwinne@stcom.us](mailto:pschwinne@stcom.us)

**David A. Strickland**

Associate Broker

770-377-3078

[dstrickland@stcom.us](mailto:dstrickland@stcom.us)

**201 Prospect Park, Suite A, Peachtree City, GA 30269**

# MAPS

1000 Commerce Drive, Peachtree City, GA 30269

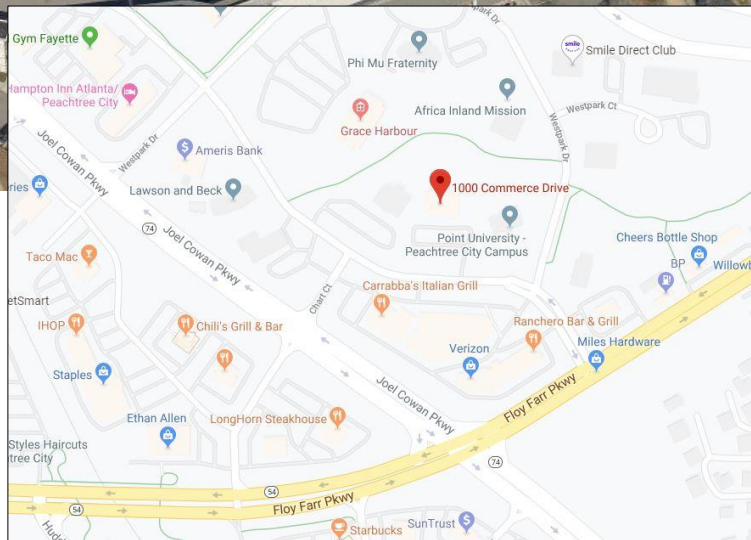

**Office: 770-631-0499**

**Web: [stcom.us](http://stcom.us)**

*This information has been secured from sources we deem reliable, but we make no representations or warranties, expressed or implied as to the accuracy of the information.*



**SOUTHTREE**  
COMMERCIAL

**REAL ESTATE**

**Paul Schwinne, CCIM**

Broker

678-296-1588

[pschwinne@stcom.us](mailto:pschwinne@stcom.us)

**David A. Strickland**

Associate Broker

770-377-3078

[dstrickland@stcom.us](mailto:dstrickland@stcom.us)

**201 Prospect Park, Suite A, Peachtree City, GA 30269**

# FLOOR PLAN

1000 Commerce Drive, Peachtree City, GA 30269

Future Tenant (s): +/- 3,987 SF

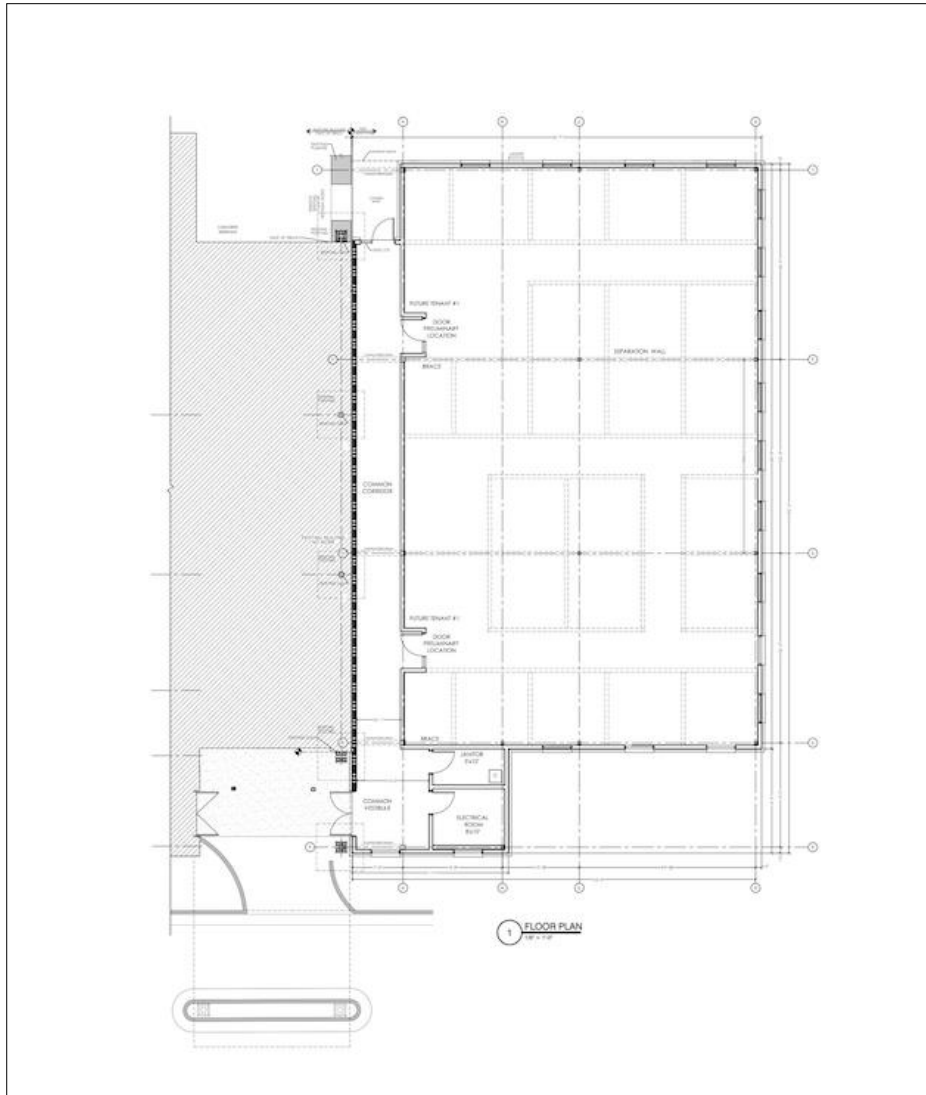

**Office: 770-631-0499**

**Web: stcom.us**

*This information has been secured from sources we deem reliable, but we make no representations or warranties, expressed or implied as to the accuracy of the information.*



**SOUTHTREE**  
C O M M E R C I A L

**REAL ESTATE**

**Paul Schwinne, CCIM**

Broker

678-296-1588

pschwinne@stcom.us

**David A. Strickland**

Associate Broker

770-377-3078

dstrickland@stcom.us

**201 Prospect Park, Suite A, Peachtree City, GA 30269**