

## NORTH COWETA BUSINESS PARK - TWO SUITES AVAILABLE

### Property details

- Development by Southtree Commercial
- Industrial space
- 76,920+/- SF in two buildings
- Property is located approximately 1 mile off of I-85 South at Exit 51 in North Coweta County

### Building Details

**Building 1:** 49,920+/- SF (75 ft deep x 360 ft wide)

- **FULLY LEASED**

**Building 2:** 27,000+/- SF (120 ft deep x 416 ft wide)

- **All Front Load Doors:** 14'x10' Drive-in door
- **Suite Details:** 6,750 SF each, fully built out with foyer area, 2 offices, and 2 bathrooms
- **Clear Height:** 16'4"
- **Column Spacing:** Clear Span
- **Opex:** \$2.00 PSF
- **Suites Available:**
  - Suite 173 & 177
  - 6,750 - 13,500 SF
  - Can be subdivided or combined

THIS INFORMATION HAS BEEN SECURED FROM SOURCES WE DEEM RELIABLE, BUT WE MAKE NO REPRESENTATIONS OR WARRANTIES, EXPRESSED OR IMPLIED AS TO THE ACCURACY OF THE INFORMATION.





**SOUTHTREE**  
COMMERCIAL

REAL ESTATE

# SITE PLAN

165-193 ELZIE JOHNSON ROAD, NEWNAN, GA 30265

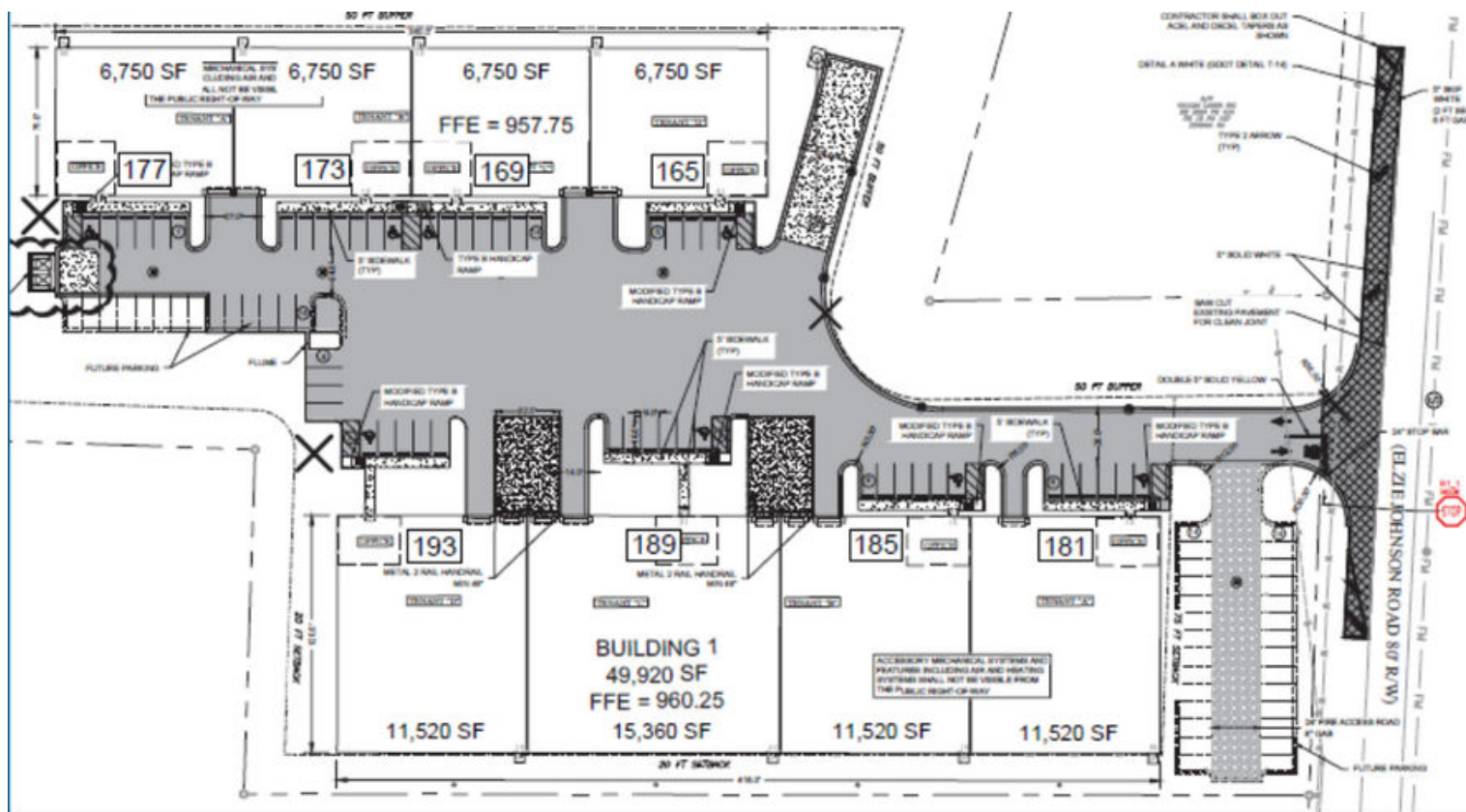

SITE PLAN NOTES:

BUILDING AREA

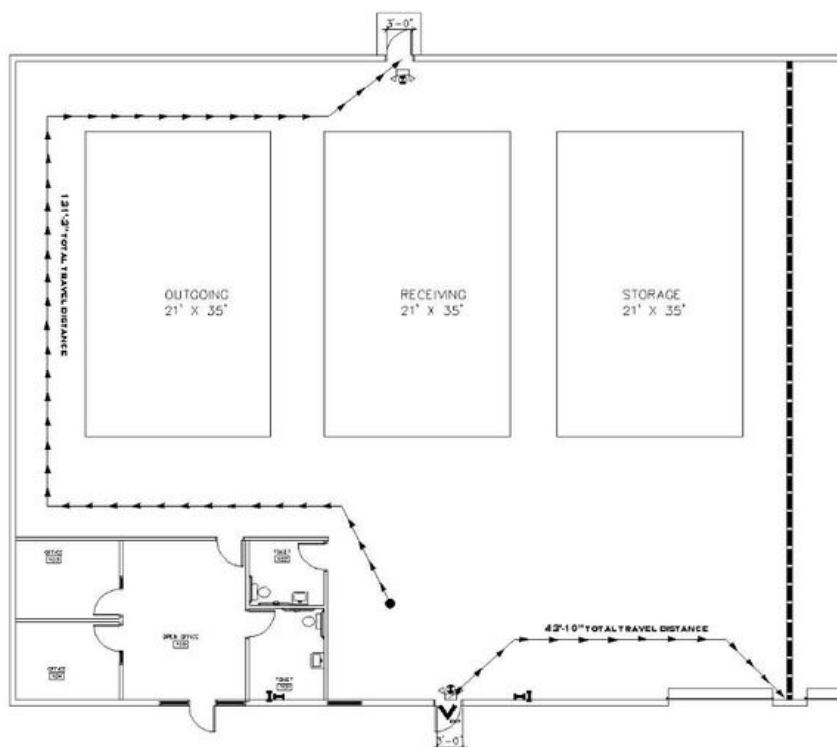

THIS INFORMATION HAS BEEN SECURED FROM SOURCES WE DEEM RELIABLE, BUT WE MAKE NO REPRESENTATIONS OR WARRANTIES, EXPRESSED OR IMPLIED AS TO THE ACCURACY OF THE INFORMATION.

**BARRY GARNER**  
COMMERCIAL AGENT  
770-294-4027  
BGARNER@STCOM.US

**PAUL SCHWINNE, CCIM**  
BROKER  
678-296-1588  
PSCHWINNE@STCOM.US



STCOM.US



770-631-0499



201 PROSPECT PARK, SUITE A,  
PEACHTREE CITY, GA 30269



SOUTHTREE  
COMMERCIAL

REAL ESTATE

# MAP

165-193 ELZIE JOHNSON ROAD, NEWNAN, GA 30265



## DISTANCE TO SITE (MILES)

I-85	1
I-285	22
Downtown Atlanta (via I-85)	32
Hartsfield-Jackson Atlanta International Airport	21

THIS INFORMATION HAS BEEN SECURED FROM  
SOURCES WE DEEM RELIABLE, BUT WE MAKE NO  
REPRESENTATIONS OR WARRANTIES, EXPRESSED OR  
IMPLIED AS TO THE ACCURACY OF THE  
INFORMATION.

BARRY GARNER  
COMMERCIAL AGENT  
770-294-4027  
BGARNER@STCOM.US

PAUL SCHWINNE, CCIM  
BROKER  
678-296-1588  
PSCHWINNE@STCOM.US



STCOM.US



770-631-0499



201 PROSPECT PARK, SUITE A,  
PEACHTREE CITY, GA 30269