

# FOR LEASE

165-193 Elzie Johnson Road, Newnan, GA 30265

## North Coweta Business Park

### PROPERTY DETAILS

- Another quality development by Southtree Commercial.
- Industrial Space.
- 76,920+/- SF in two buildings.
- The property is located approximately 1 mile off of I-85 South at Exit 51 in North Coweta County.
- Office Space BTS.

### BUILDING DETAILS

**Building 1:** 49,920+/- SF (75 ft deep x 360 ft wide)

**All Front Load Doors:** Dock (4) and Drive-in (2)

**Suite Sizes:** 12,000 – 38,520 SF

**Clear Height:** 20'2"

**Column Spacing:** 32 x 60 (one column down centerline)

**Opex:** \$2.00 PSF

**Building 2:** 27,000+/- SF (120 ft deep x 416 ft wide)

**All Front Load Doors:** only Drive-in (4)

**Suite Sizes:** 6,000 – 27,000 SF

**Clear Height:** 16'4"

**Column Spacing:** Clear Span

**Opex:** \$2.00 PSF



**Office: 770-631-0499**

**Web: stcom.us**

*This information has been secured from sources we deem reliable, but we make no representations or warranties, expressed or implied as to the accuracy of the information.*



**SOUTHTREE**  
COMMERCIAL

**REAL ESTATE**

**Barry Garner**  
Commercial Agent  
770-294-4027  
bgarner@stcom.us

**Paul Schwinne, CCIM**  
Broker  
678-296-1588  
pschwinne@stcom.us

201 Prospect Park, Suite A, Peachtree City, GA 30269

# SITE PLAN

165-193 Elzie Johnson Road, Newnan, GA 30265

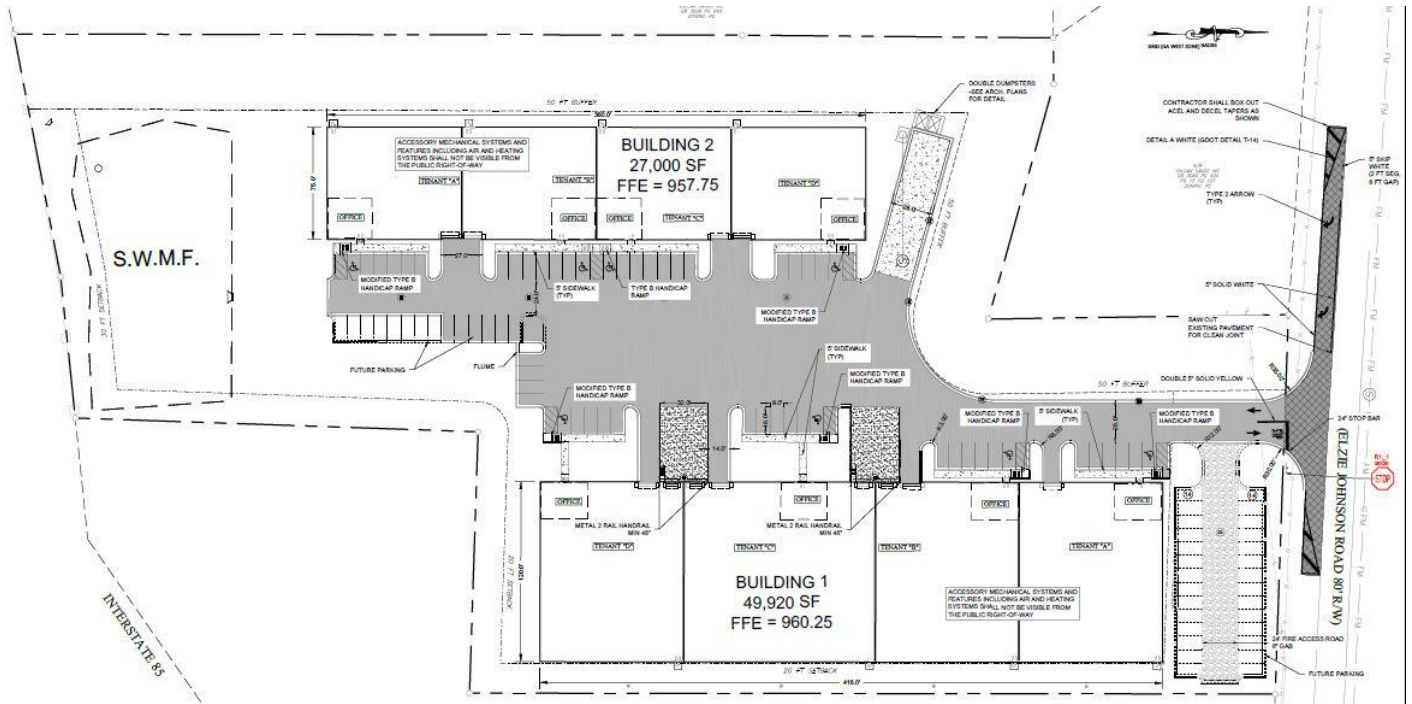

**Office: 770-631-0499**  
**Web: stcom.us**

*This information has been secured from sources we deem reliable, but we make no representations or warranties, expressed or implied as to the accuracy of the information.*



**SOUTHTREE**  
COMMERCIAL

**REAL ESTATE**

**Barry Garner**  
Commercial Agent  
770-294-4027  
bgarner@stcom.us

**Paul Schwinne, CCIM**  
Broker  
678-296-1588  
pschwinne@stcom.us

201 Prospect Park, Suite A, Peachtree City, GA 30269

# MAP

165-193 Elzie Johnson Road, Newnan, GA 30265



Distance to Site (Miles)	
I-85	1
I-285 (via I-85)	22
Downtown Atlanta (via I-85)	32
Hartsfield-Jackson Atlanta International Airport	21

**Office: 770-631-0499**

**Web: stcom.us**

*This information has been secured from sources we deem reliable, but we make no representations or warranties, expressed or implied as to the accuracy of the information.*



**SOUTHTREE**  
COMMERCIAL

**REAL ESTATE**

**Barry Garner**  
Commercial Agent  
770-294-4027  
bgarner@stcom.us

**Paul Schwinne, CCIM**  
Broker  
678-296-1588  
pschwinne@stcom.us

201 Prospect Park, Suite A, Peachtree City, GA 30269